

LOCATION MAP (SCALE 1:1000)

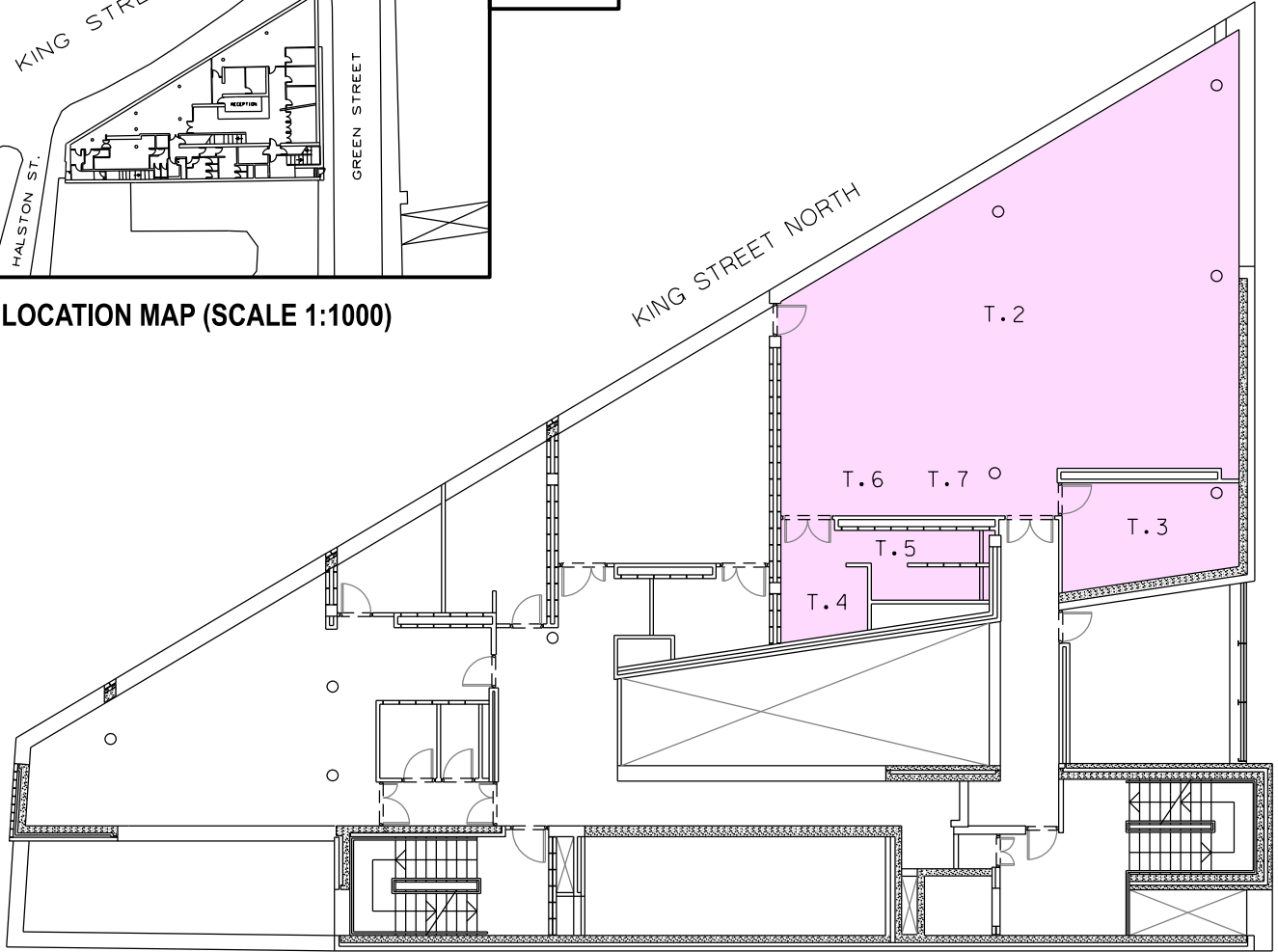

THIRD FLOOR PLAN (SCALE 1:200)

HALSTON STREET / NORTH KING STREET / GREEN STREET - MACRO BUILDING  
 Rooms T.02, T.03, T.04, T.05, T.06, T.07 (AREA: 141.2 sq m)  
 Dublin City Council to MACRO Building Management CLG  
 GRANT OF LICENCE

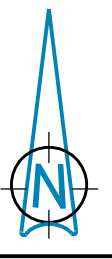

Comhairle Cathrach  
 Bhaile Átha Cliath  
 Dublin City Council

An Roinn Comhshaoil agus Iompair  
 Rannán Suirbhéireachta agus Léarscáilithe  
 Environment and Transportation Department  
 Survey and Mapping Division

<b>O.S REF</b>	<b>SCALE</b>
3263-04, 3263-05	1:1000 / 1:200
<b>DATE</b>	<b>SURVEYED / PRODUCED BY</b>
26.04.2022	TJC

<b>INDEX No</b>	<b>DWG No</b>	<b>REV</b>
<b>FILE NO</b>	F:\SM-2022-0195 - 001 - A.dgn	

THIS MAP IS CERTIFIED TO BE COMPUTER GENERATED BY  
 DUBLIN CITY COUNCIL FROM ORDNANCE SURVEY DIGITAL MAPBASE  
 SURVEY, MAPPING AND RELATED RESEARCH APPROVED  
 APPROVED \_\_\_\_\_  
**THOMAS CURRAN**  
 ACTING MANAGER LAND SURVEYING & MAPPING  
 DUBLIN CITY COUNCIL

**INDEX No.**  
**SM-2022-0195**

**Dr JOHN W. FLANAGAN**  
 CEng FIEI FICE  
**CITY ENGINEER**